

# HAPPY CAMP

30550 LONGHORN DR.  
CANYON LAKE, CA 92587



## EMERGENCY CONTACTS

**CAMPGROUND** 951-244-6841 EXT 650/651  
951-246-1765  
**COMMUNITY PATROL** 951-244-5950  
**FIRE AND RESCUE** 911  
**FIRE DEPARTMENT** 951-903-6037  
**POLICE** 911  
**POLICE** 911  
**NON-EMERGENCY** 1-800-950-2444  
**EMERGENCY PAGER** 951-270-4950 PAGER  
**CITY HALL** 951-244-2955  
**OPERATIONS OFFICE** 951-244-6841 EXT 510  
**OPERATIONS MNGR** 951-232-8237  
**LAKE MANAGEMENT** 951-232-3209 CELL

**CITY CODE ENFORCEMENT** 951-244-3935  
951-265-1796 CELL  
**CITY MANAGER** 951-903-6037 CELL

**NATIONAL RESPONSE CENTER (NRC)**  
1-800-424-8802

**CHEMTREC (24 hour Emergency Response)**  
1-800-424-9300

## MEDICAL SERVICES

**INLAND VALLEY MEDICAL CENTER**  
36485 Inland Valley Dr  
Wildomar, Ca 92595 909-677-1111

**TOTAL CARE URGENT CARE**  
425 Diamond Dr. 104-105  
Lake Elsinore, Ca 92530 951-674-1403

PLEASE NOTICE: that the "Emergency Evacuation Staging Area" is on Longhorn Dr. just outside the main entrance to Happy Camp. In case of emergency calmly walk to this area unless otherwise directed by response personnel. Do not start your vehicles unless directed by response personnel. Please shut off all appliances and turn off gas.

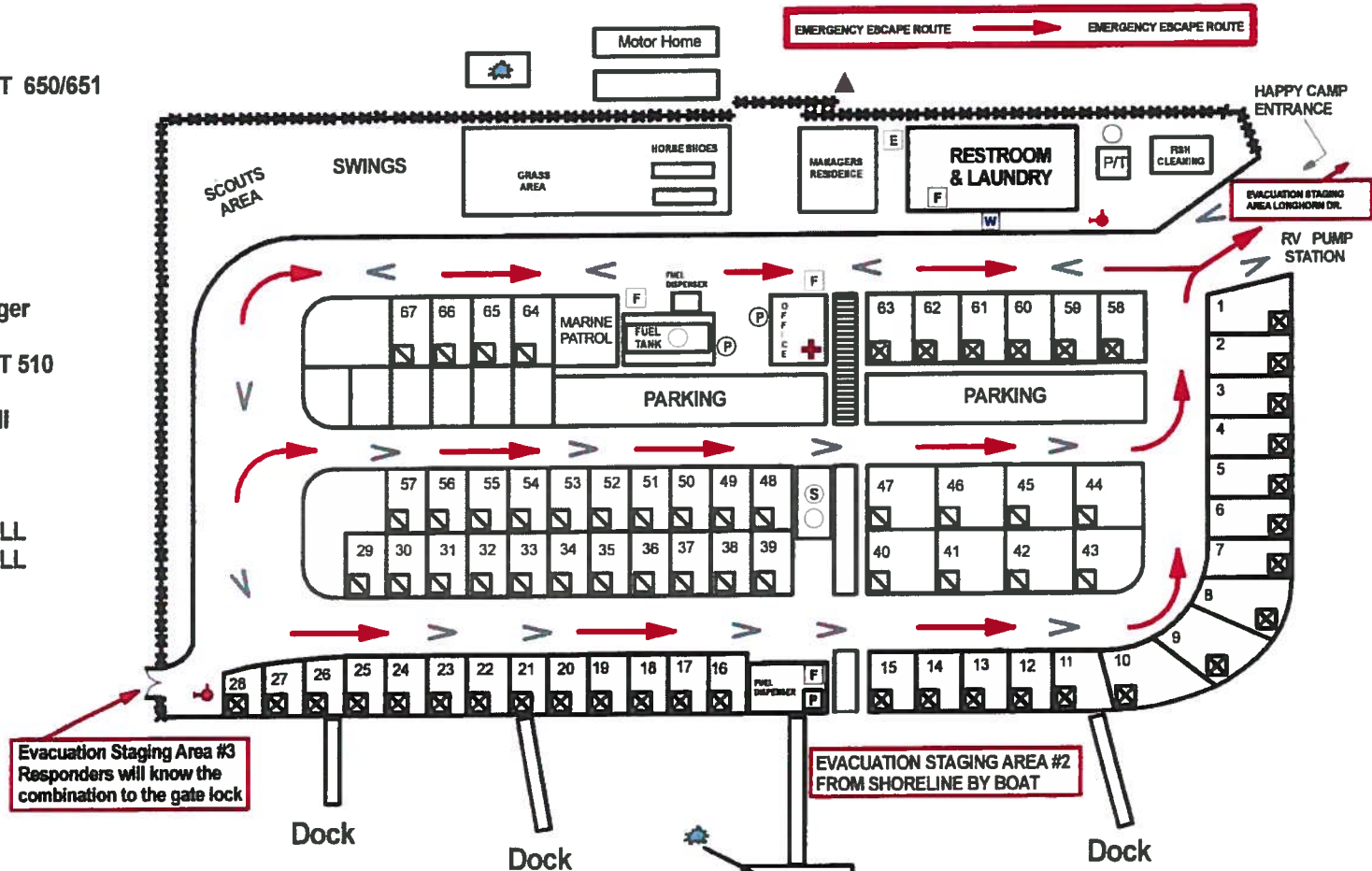

Evacuation Staging Area #3  
Responders will know the combination to the gate lock

EVACUATION STAGING AREA #2  
FROM SHORELINE BY BOAT

## Map Legend

- FULL HOOK UPS
- WATER & ELECTRIC
- FENCE
- FIRST AID
- NORMAL TRAFFIC FLOW
- PROPANE TANK
- TOOL SHED
- Spill Materials
- ELECTRIC METER
- FIRE EXTINGUISHER
- PUMP SHUT OFF
- WATER METER AND MAIN SHUT OFF
- FIRE HYDRANT
- SEWER
- ABOVE GROUND TANK
- Evacuation Areas 1, 2, & 3



Please notify the Happy Camp personnel of any special needs you may have during power outages or emergencies such as earthquakes, fire or floods.